

Special Award Judges' Parking Guide and Maps

Colorado Science & Engineering Fair (CSEF)

April 3, 2025

FREE Off-Campus Parking and Shuttle to Campus: Due to the limited amount of on-campus parking and the increased cost of a visitor parking permit, CSEF has arranged for off-campus parking and a **free shuttle** to take people to/from the Lory Student Center (LSC) on **Thursday, April 3rd ONLY**. Free parking will be guaranteed at **Timberline Church on Timberline from 7 a.m. - 6:00 p.m.**

DROP OFF & PICK UP: The CSEF Shuttle Buses from Timberline Church will be dropping people off on Meridian Avenue west of the Lory Student Center and NOT at the Transit Center. To reach the student center, you will take the pedestrian walkway towards the East to the Lory Student Center. Enter near the theater and head upstairs to room 302.

For those of you coming from off-campus locations, there is construction going on throughout Fort Collins and on the CSU campus. Please make sure that you allow plenty of time to get to Timberline Church or LSC and check parking maps on the CSU web site before you come, for updates. For a map of the whole campus, please go to <https://map.concept3d.com/>.

As long as there are no unexpected road closures, you can follow these directions to reach Timberline Church on Timberline Road:

From I-25 South & North of Fort Collins: Take Exit 265 (Harmony Road) west to Timberline Road. Turn North (right) onto Timberline past Fort Collins High School to Custer Drive. Turn East (right) onto Custer Drive and turn into the church parking lot at either the second or third streets to the South. **Please park only in the northeast corner of the church lot so as not to interfere with any of the church's other activities going on that day.**

CSU shuttle buses will run between the Timberline Church and Meridian Avenue on **Thursday between 7 a.m. and 6:00 p.m. roughly every half hour** (please note that only ONE bus will run between 12 noon. and 4 p.m.). When you arrive at the LSC, the **Special Award Judges' Check-In is outside of Room 300** (see attached 300 level map).

On-Campus Parking Options: For those who want or need to park on campus Thursday for judging or who are visiting campus to take part of CSEF activities on Friday, you will be on your own for parking.

- Daily parking permits may be purchased from Parking Services online (<https://colostate.t2hosted.com/per/index.aspx>) using the Guest Login or at the Lake & Center Parking Garage. The cost is **\$13/day**. You must have your vehicle's make, model, year, and license plate number when you purchase a permit.
- Most lots have hourly metered parking spots during permit hours (most lots are enforced 7:30 a.m. to 4 p.m. daily). **Meter costs are \$2/hour and machines only accept credit cards for payment.** Check the signs posted in each lot for enforcement times; some lots have extended enforcement hours. The lots that have time limits of up to 8 ½ hours include #195 (Moby), #310 (Engineering), #425 (Morgan Library), #570 (Lake Street Garage), #577 (South College Garage), #725 (Vet Teaching Hospital) & #740 (Tennis Pavilion).
- The parking lots that are closest to the LSC (but fill up fast!) are Lot #310 (Engineering) and Lot #425 (Morgan Library). Please note that the North end of the Lory Student Center is under construction on the 3rd floor and so access there is limited.
- **ALL** vehicles, even those with state or federal plates **require** a parking permit.

- Parking for people with a valid handicapped permit may park in any of the marked handicapped stalls, but must have a CSU parking permit or pay the meters, if applicable.
- CARPOOL!! CARPOOL!!
- Around the Horn is a free-on-campus shuttle that connects to most visitor parking lots with a bus that loops campus every 10 minutes from 7 a.m. to 6:40 p.m. Monday through Friday. (www.ridetransfort.com/routes/horn)
- The parking lots that have visitor parking available and are connected to Around the Horn are: Lot #195 (Moby); Lot #440 (University Station); Lot #570 (Lake Street Garage); Lot #725 (Vet Teaching Hospital); and Lot #740 (Tennis Pavilion).
- BE AWARE that even if you purchase a parking permit, CSU does not guarantee a parking space.

CSEF is **NOT** responsible for parking citations issued by CSU to CSEF finalists, their parents, teachers or any of the judges and volunteers. Parking information and costs provided herein are subject to change by CSU at any time, so please read and follow the instructions on posted signs in the CSU parking lots.

Shuttle Drop-off Map



Timberline Church Parking Map



100 LEVEL

200 LEVEL

300 LEVEL

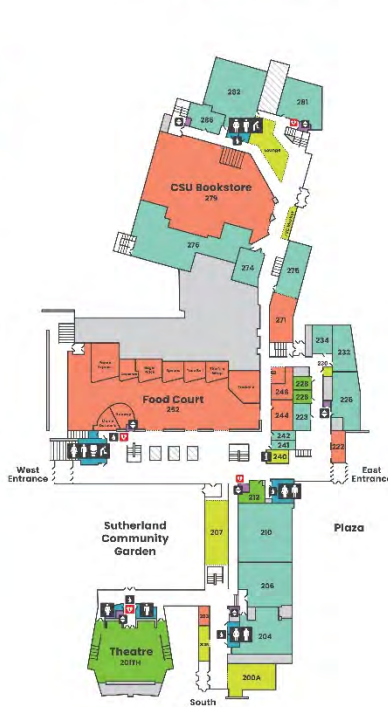

100 LEVEL

VENDORS	152	Ramskeller Pub & Grub	EVENT SPACE	134	Meeting Room	AMENITIES	139	Laptop & Technology Checkout	OFFICES	118	Rocky Mountain Student Media Corporation		
	176	CSU Bookstore		140	Meeting Room		150	Commons/Sunivan Lounge		120	Career Center	120	Career Center
	176	Cam's Lolly Shop		144	Meeting Room		193	Campus Info 2		130	Campus Activities	141	Student Organization Resource Center
	197	Recycled Cycles		152A	Microbrewery Classroom					141	Student Organization Resource Center	142	Fraternity & Sorority Life
										193	Campus Info 2	195	Transport

200 LEVEL

VENDORS	203	Intermissions	EVENT SPACE	207H	LSC Theatre	AMENITIES	200A	Curfman Gallery	OFFICES	204	ASCSU Senate Chamber		
	222	Sweet Sensations		212	Meeting Room		207	Diane Warren Kindness Lounge		206	Associated Students of Colorado State University	206	Associated Students of Colorado State University
	244	RAMtech		225	Meeting Room		230	Study Room		210	Student Leadership, Involvement & Community Engagement (SLICE)	210	Student Leadership, Involvement & Community Engagement (SLICE)
	246	First National Bank		228	Meeting Room		240	Campus Info and Box Office		223	Student Disability Center	223	Student Disability Center
	252	Food Court								225	El Centro	225	El Centro
	Bagel Place							232	Pride Resource Center				
	Meddy's							232	Pride Resource Center				
	Garbanzo							234	Women and Gender Advocacy Center				
	Maria DeLuca's							242	Colorado State University Police Department				
	Panda Express							274	Student Legal Services				
	Spoons							275	RamCard Office				
	Subway							276	LSC Business Services				
	Taco Bell							281	Off-Campus Life				
	That's a Wrap							282	Adult Learner and Veteran Services				
	271	Canvas Credit Union						286	LSC Operations				
	279	CSU Bookstore											

300 LEVEL

VENDORS	399B	Aspen Grille	EVENT SPACE	300, 304, 306, 308, 310, 312, 322, 324, 328, 330, 372, 374, 376, 378, 380, 381A, 382, 384, 386, 390, 392, 394, 396, 398	Meeting Rooms	AMENITIES	316	Paul & Elsie Forsythe Legacy Lounge	OFFICES	303	Executive Director's Office		
				302	Longs Peak Room		320	Duessa Gallery		315	Event Planning Services	327	Native American Cultural Center
				350	Grand Ballroom A-D		326	Study Room		332	Study Room	333	Asian/Pacific American Cultural Center
				357	Never No Summer (N3N5 Black)		336	Study Room		337	Lactation Room	335	Black/African American Cultural Center
				398A	University Ballroom		366	Reflection Room		366	Reflection Room		
		399	University Lounge	398	Reflection Room	367B	Lactation Room						

LEGEND

- RESTROOM
- CHANGING STATION
- ELEVATOR
- INFO DESK
- ALL-GENDER RESTROOM
- LACTATION ROOM
- WATER STATION
- AED

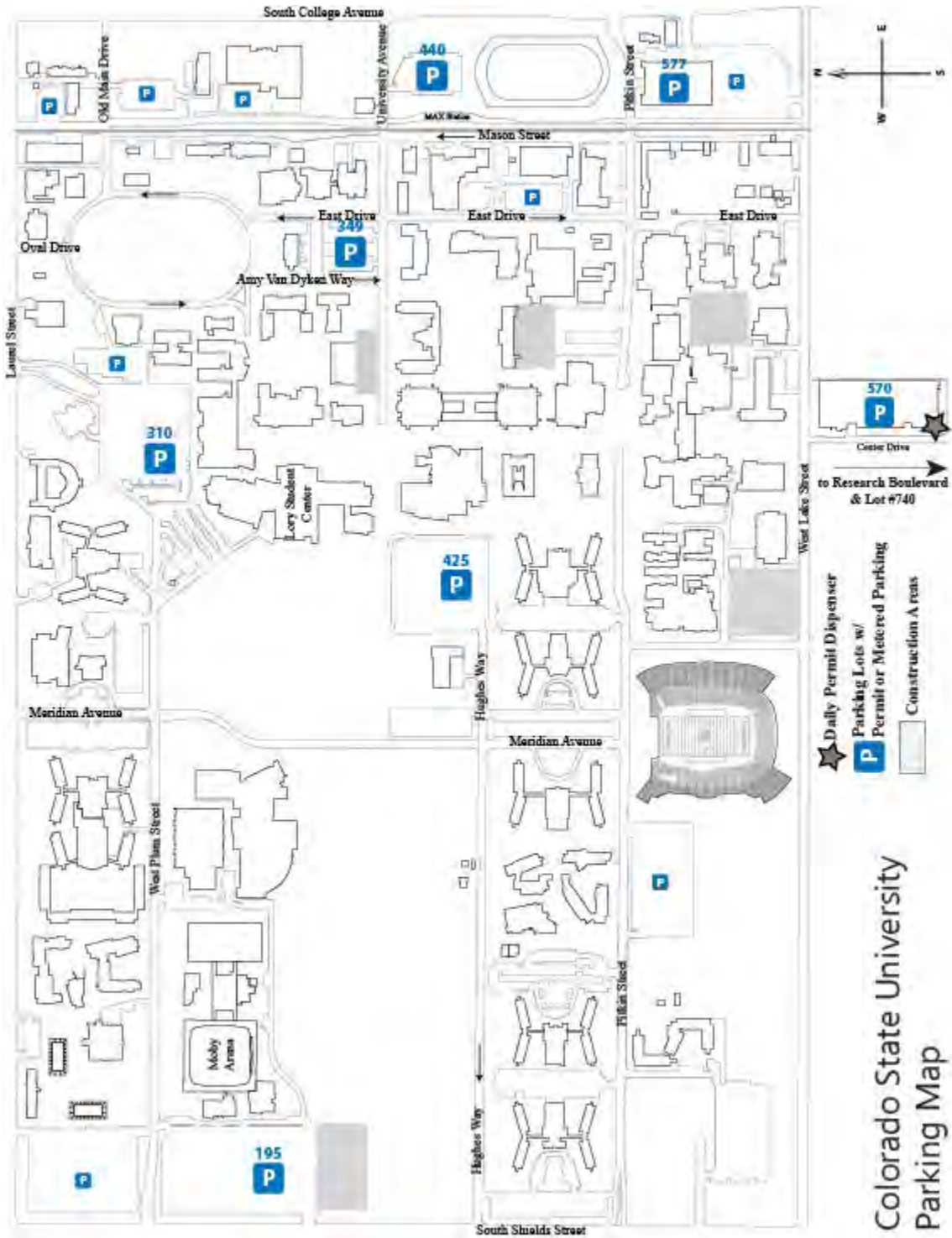

Colorado State University Parking Map