

Special Award Judges' Parking Guide and Maps

Colorado Science & Engineering Fair (CSEF)

April 11, 2024

FREE Off-Campus Parking and Shuttle to Campus: Due to the limited amount of on-campus parking and the increased cost of a visitor parking permit, CSEF has arranged for off-campus parking and a **free shuttle** to take people to/from the Lory Student Center (LSC) on **Thursday, April 11th ONLY**. Free parking will be guaranteed at **Timberline Church on Timberline from 7 a.m. - 6:00 p.m.**

DROP OFF & PICK UP: The CSEF Shuttle Buses from Timberline Church will be dropping people off on Meridian Avenue west of the Lory Student Center and NOT at the Transit Center. To reach the student center, you will take the pedestrian walkway towards the East to the Lory Student Center. Enter near the theater and head upstairs to room 302.

For those of you coming from off-campus locations, there is construction going on throughout Fort Collins and on the CSU campus. Please make sure that you allow plenty of time to get to Timberline Church or LSC and check parking maps on the CSU web site before you come, for updates. For a map of the whole campus, please go to <https://map.concept3d.com/>.

As long as there are no unexpected road closures, you can follow these directions to reach Timberline Church on Timberline Road:

From I-25 South & North of Fort Collins: Take Exit 265 (Harmony Road) west to Timberline Road. Turn North (right) onto Timberline past Fort Collins High School to Custer Drive. Turn East (right) onto Custer Drive and turn into the church parking lot at either the second or third streets to the South. **Please park only in the northeast corner of the church lot so as not to interfere with any of the church's other activities going on that day.**

CSU shuttle buses will run between the Timberline Church and Meridian Avenue on **Thursday between 7 a.m. and 6:00 p.m. roughly every half hour** (please note that only ONE bus will run between 12 noon. and 4 p.m.). When you arrive at the LSC, the **Special Award Judges' Check-In is outside of Room 300** (see attached 300 level map).

On-Campus Parking Options: For those who want or need to park on campus Thursday for judging or who are visiting campus to take part of CSEF activities on Friday, you will be on your own for parking.

- Daily parking permits may be purchased from Parking Services online (<https://colostate.t2hosted.com/per/index.aspx>) using the Guest Login or at the Lake & Center Parking Garage. The cost is **\$13/day**. You must have your vehicle's make, model, year, and license plate number when you purchase a permit.
- Most lots have hourly metered parking spots during permit hours (most lots are enforced 7:30 a.m. to 4 p.m. daily). **Meter costs are \$2/hour and machines only accept credit cards for payment.** Check the signs posted in each lot for enforcement times; some lots have extended enforcement hours. The lots that have time limits of up to 8 ½ hours include #195 (Moby), #310 (Engineering), #425 (Morgan Library), #570 (Lake Street Garage), #577 (South College Garage), #725 (Vet Teaching Hospital) & #740 (Tennis Pavilion).
- The parking lots that are closest to the LSC (but fill up fast!) are Lot #310 (Engineering) and Lot #425 (Morgan Library). Please note that the North end of the Lory Student Center is under construction on the 3rd floor and so access there is limited.
- **ALL** vehicles, even those with **state or federal plates** require a parking permit.

- Parking for people with a valid handicapped permit may park in any of the marked handicapped stalls, but must have a CSU parking permit or pay the meters, if applicable.
- CARPOOL!! CARPOOL!!
- Around the Horn is a free-on-campus shuttle that connects to most visitor parking lots with a bus that loops campus every 10 minutes from 7 a.m. to 6:40 p.m. Monday through Friday. (www.ridetransfort.com/routes/horn)
- The parking lots that have visitor parking available and are connected to Around the Horn are: Lot #195 (Moby); Lot #440 (University Station); Lot #570 (Lake Street Garage); Lot #725 (Vet Teaching Hospital); and Lot #740 (Tennis Pavilion).
- BE AWARE that even if you purchase a parking permit, CSU does not guarantee a parking space.

CSEF is **NOT** responsible for parking citations issued by CSU to CSEF finalists, their parents, teachers or any of the judges and volunteers. Parking information and costs provided herein are subject to change by CSU at any time, so please read and follow the instructions on posted signs in the CSU parking lots.

Shuttle Drop-off Map

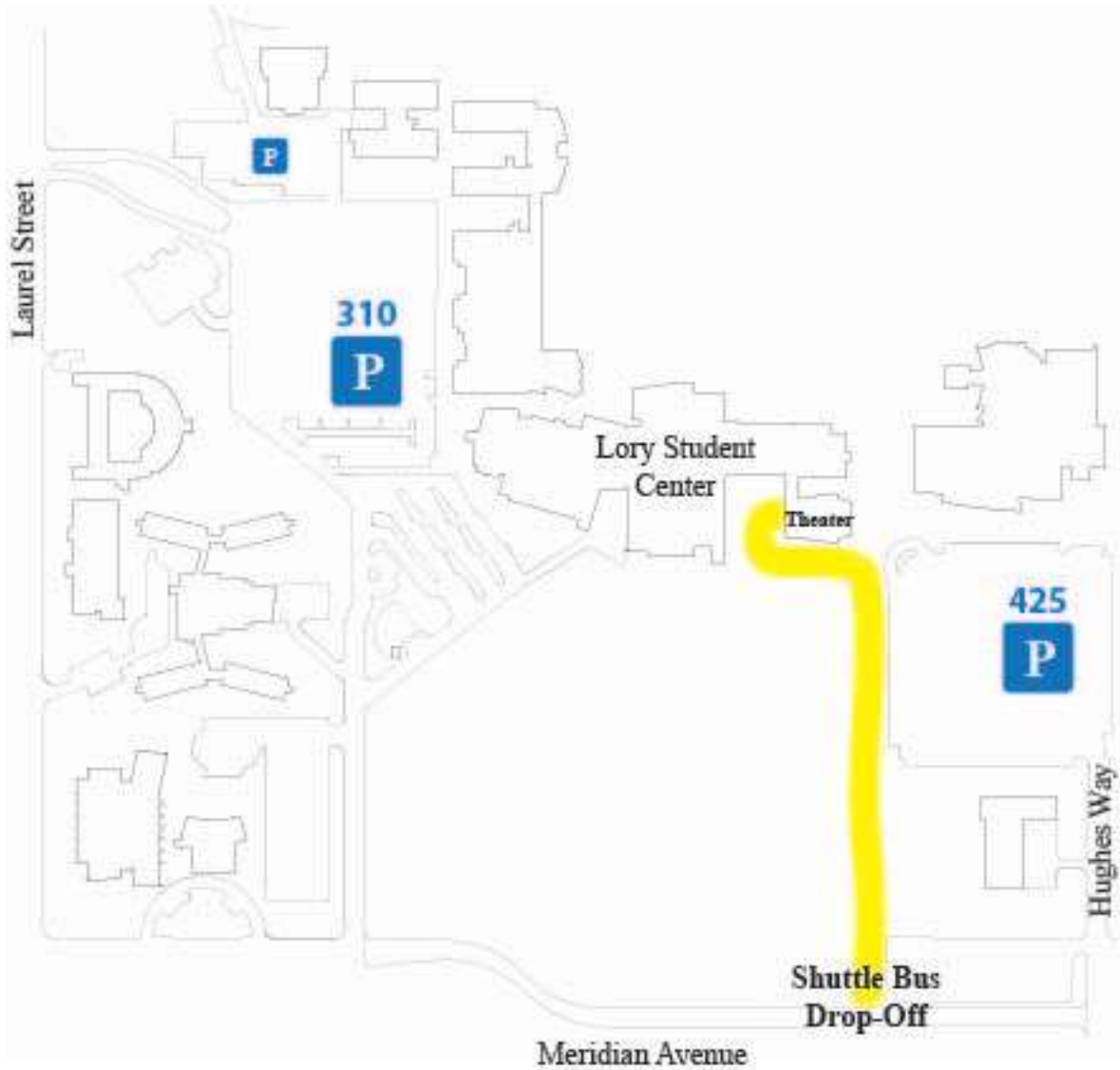

Timberline Church Parking Map



LSC BUILDING MAPS

100 LEVEL

200 LEVEL

300 LEVEL

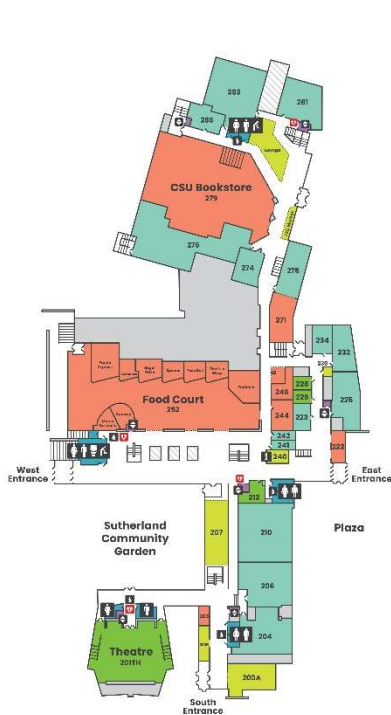

100 LEVEL

VENDORS	152 Ramskeller Pub & Grub	EVENT SPACE	134 Meeting Room	AMENITIES	139 Laptop & Technology	OFFICES	118 Rocky Mountain
	178 CSU Bookstore		140 Meeting Room		150 Commons/Sunken Lounge		120 Career Center
	176 Bagel Place 2		144 Meeting Room		193 Campus Info 2		130 Campus Activities
	178 Cam's Lobby Shop		152A Microbrewery Classroom				141 Student Organization
197 Recycled Cycles							142 Fraternity & Sorority Life
							195 Transfort

200 LEVEL

VENDORS	203 Intermissions	EVENT SPACE	201H LSC Theatre	AMENITIES	200A Curfman Gallery	OFFICES	204 ASCSU Senate Chamber
	222 Sweet Sinuations		212 Meeting Room		207 Diane Warren		205 Associated Students of
	244 RAMtech		225 Meeting Room		230 Study Room		210 Student Leadership,
	246 First National Bank		228 Meeting Room		240 Campus Info and Box Office		210 Involvement & Community
	252 Food Court			223 Student Disability Center			
	Bagel Place			225 El Centro			
	Preloy's			232 Pride Resource Center			
Garbanzo			234 Women and Gender				
Maria DeLuca's			242 Colorado State University				
Panda Express			242 Police Department				
Spoons			274 Student Legal Services				
Subway			275 RamCard Office				
Taco Bell			276 LSC Business Services				
That's a Wrap			281 Off-Campus Life				
271 Canvas Credit Union			282 Adult Learner and				
279 CSU Bookstore			286 LSC Operations				

300 LEVEL

VENDORS	398 Aspen Grille	EVENT SPACE	Meeting Rooms	AMENITIES	316 Paul & Elsie Forsythe	OFFICES	303 Executive Director's Office
			300, 304, 306, 308, 310, 312, 322, 324, 328, 330, 372, 374, 376, 378, 380, 381A, 382, 384, 388, 390, 392, 394, 396, 398		316 Legacy Lounge		315 Event Planning Services
			302 Longs Peak Room	320 Duessa Gallery	326 Study Room		327 Native American Cultural Center
			350 Grand Ballroom A-D	332 Study Room	336 Study Room		333 Asian/Pacific American Cultural Center
			357 Never No Summer (No on Board)	337 Lactation Room	366 Reflection Room		335 Black/African American Cultural Center
			398A University Ballroom	368 Reflection Room	368 Lactation Room		
			399 University Lounge	367B Lactation Room			

LEGEND

- RESTROOM
- CHANGING STATION
- ELEVATOR
- INFO DESK
- ALL-GENDER RESTROOM
- LACTATION ROOM
- WATER STATION
- AED

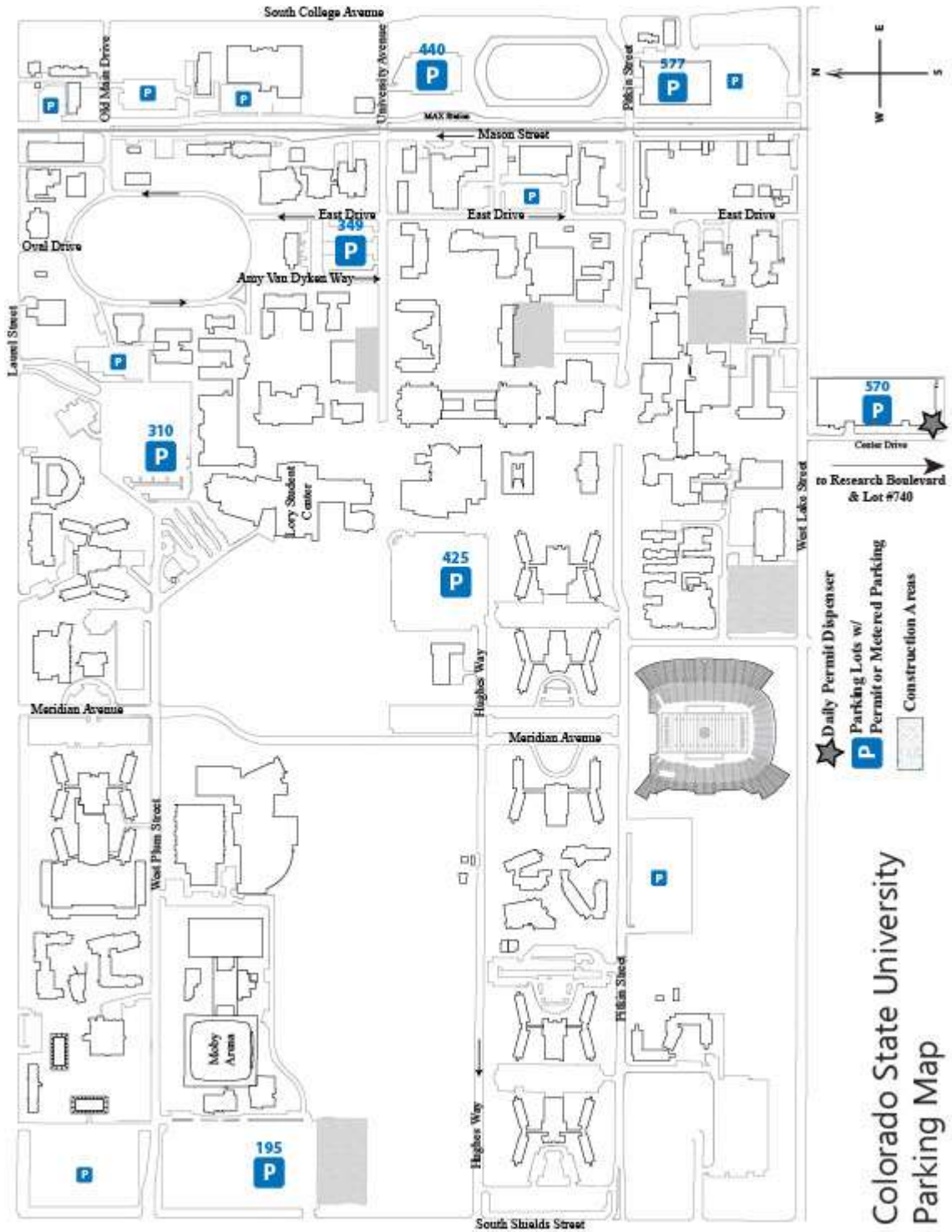

Colorado State University
Parking Map