

# Grand Award Judges' Parking Guide and Maps

## Colorado Science & Engineering Fair (CSEF)

### April 11, 2024

**FREE Off-Campus Parking and Shuttle to Campus:** Due to the limited amount of on-campus parking and the increased cost of a visitor parking permit, CSEF has arranged for off-campus parking and a **free shuttle** to take people to/from the Lory Student Center (LSC) on **Thursday, April 11<sup>th</sup> ONLY**. Free parking will be guaranteed at **Timberline Church on Timberline from 7 a.m. - 6:00 p.m.**

**DROP OFF & PICK UP:** The CSEF Shuttle Buses from Timberline Church will be dropping people off on Meridian Avenue west of the Lory Student Center and NOT at the Transit Center. To reach the student center, you will take the pedestrian walkway towards the East to the Lory Student Center. The theater is on the main floor and there are entrances on the east and west side of the building.

For those of you coming from off-campus locations, there is construction going on throughout Fort Collins and on the CSU campus. Please make sure that you allow plenty of time to get to Timberline Church or LSC and check parking maps on the CSU web site before you come, for updates. For a map of the whole campus, please go to <https://map.concept3d.com/>.

As long as there are no unexpected road closures, you can follow these directions to reach Timberline Church on Timberline Road:

**From I-25 South & North of Fort Collins:** Take Exit 265 (Harmony Road) west to Timberline Road. Turn North (right) onto Timberline past Fort Collins High School to Custer Drive. Turn East (right) onto Custer Drive and turn into the church parking lot at either the second or third streets to the South. **Please park only in the northeast corner of the church lot so as not to interfere with any of the church's other activities going on that day.**

**Grand Award Judges:** CSU shuttle buses will run between the Timberline Church and Meridian Avenue on **Thursday between 7 a.m. and 6:00 p.m. roughly every half hour** (please note that only ONE bus will run between 12 noon. and 4 p.m.). When you arrive at the LSC, the **Grand Award Judges' Check-In** is **inside the LSC Theater** (see attached 200 level map).

**Category Team Captains:** **DO NOT use the Shuttle Service!** For all non-CSU faculty and students serving as a Grand Award Judge Team Captain, you have been provided a one-time campus parking permit since you will need to stay until ~7:30 p.m. We suggest you use the Library parking lot (#425 - see attached map/directions), as you will be arriving earlier than everyone else.

**Category Assistant Team Captains:** Please remember to allow plenty of time for parking and taking the shuttle to campus in order to attend the 9:15 a.m. Captain/Assistant Captains' Briefing.

On-Campus Parking Options: For those who want or need to park on campus Thursday for judging or who are visiting campus to take part of CSEF activities on Friday, you will be on your own for parking.

- Daily parking permits may be purchased from Parking Services online (<https://colostate.t2hosted.com/per/index.aspx>) using the Guest Login or at the Lake & Center Parking Garage. The cost is **\$13/day**. You must have your vehicle's make, model, year, and license plate number when you purchase a permit.
- Most lots have hourly metered parking spots during permit hours (most lots are enforced 7:30 a.m. to 4 p.m. daily). **Meter costs are \$2/hour and machines only accept credit cards for payment.** Check the signs posted in each lot for enforcement times; some lots have extended enforcement hours. The lots that have time limits of up to 8 ½ hours include #195 (Moby), #310 (Engineering), #425 (Morgan Library), #570 (Lake Street Garage), #577 (South College Garage), #725 (Vet Teaching Hospital) & #740 (Tennis Pavilion).
- The parking lots that are closest to the LSC (but fill up fast!) are Lot #310 (Engineering) and Lot #425 (Morgan Library). Please note that the North end of the Lory Student Center is under construction on the 3<sup>rd</sup> floor and so access there is limited.
- **ALL** vehicles, even those with **state or federal plates** require a parking permit.
- Parking for people with a valid handicapped permit may park in any of the marked handicapped stalls, but must have a CSU parking permit or pay the meters, if applicable.
- CARPOOL!! CARPOOL!!
- Around the Horn is a free-on-campus shuttle that connects to most visitor parking lots with a bus that loops campus every 10 minutes from 7 a.m. to 6:40 p.m. Monday through Friday. ([www.ridetransfort.com/routes/horn](http://www.ridetransfort.com/routes/horn))
- The parking lots that have visitor parking available and are connected to Around the Horn are: Lot #195 (Moby); Lot #440 (University Station); Lot #570 (Lake Street Garage); Lot #725 (Vet Teaching Hospital); and Lot #740 (Tennis Pavilion).
- BE AWARE that even if you purchase a parking permit, CSU does not guarantee a parking space.

CSEF is **NOT** responsible for parking citations issued by CSU to CSEF finalists, their parents, teachers or any of the judges and volunteers. Parking information and costs provided herein are subject to change by CSU at any time, so please read and follow the instructions on posted signs in the CSU parking lots.

# Shuttle Drop-off Map

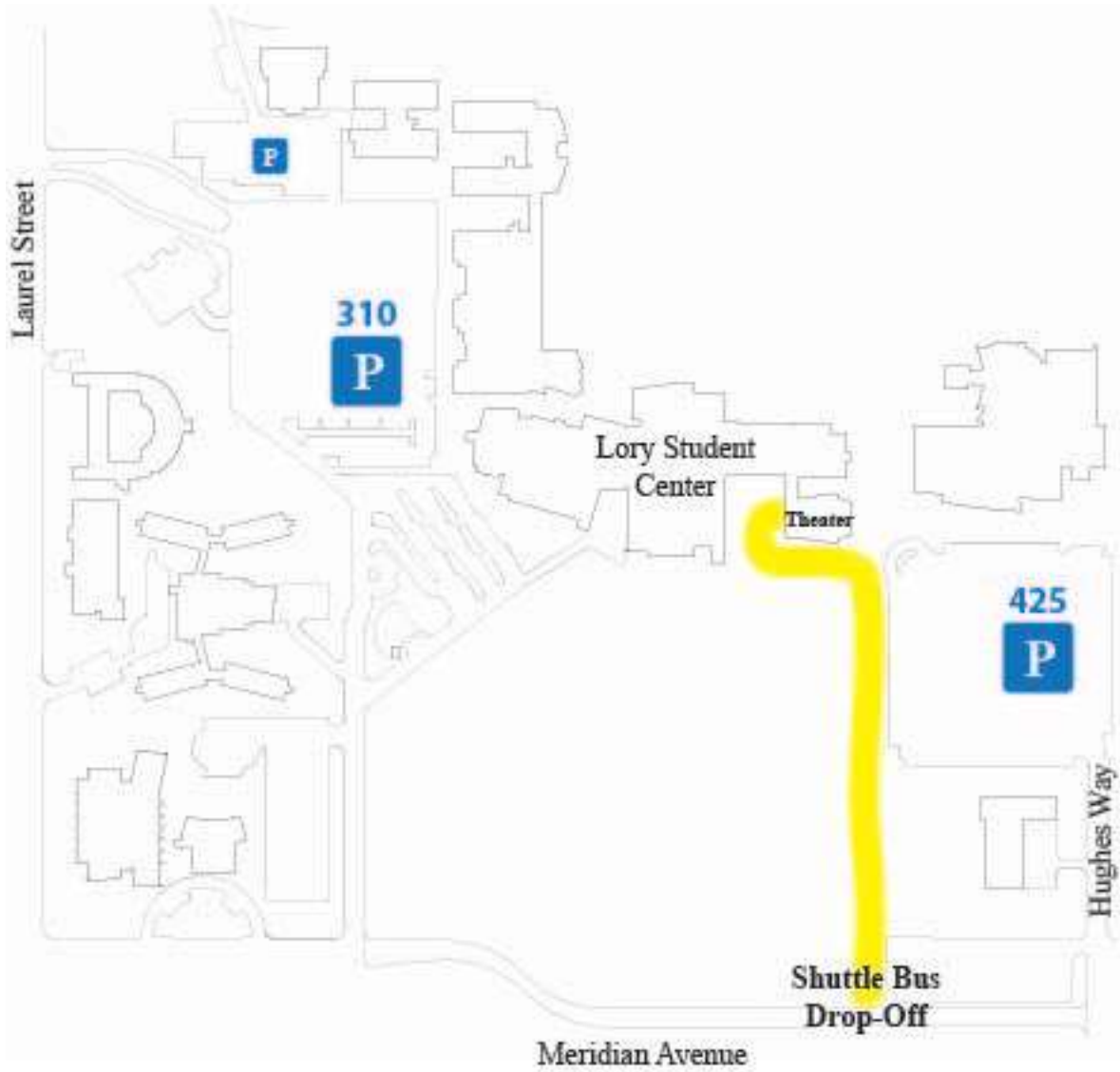

# Timberline Church Parking Map





# LSC BUILDING MAPS

## 100 LEVEL

## 200 LEVEL

## 300 LEVEL

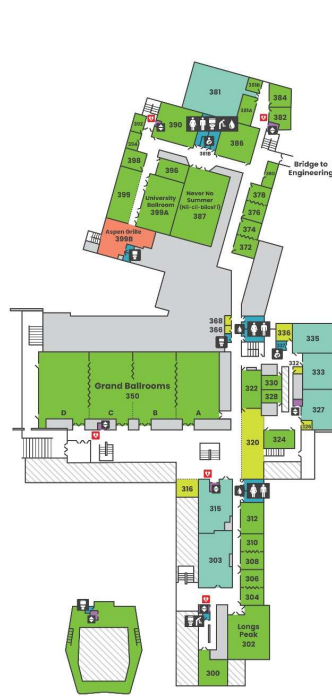
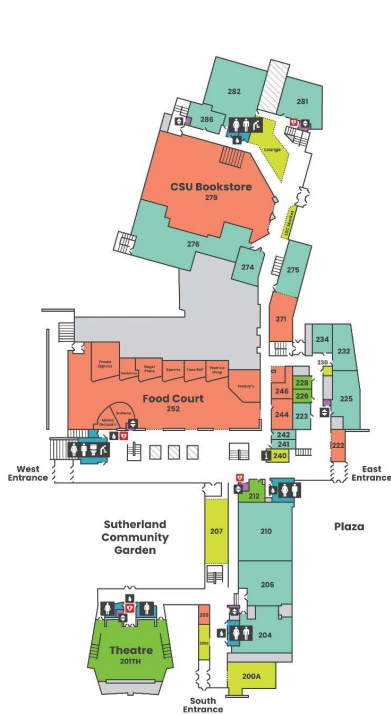

### 100 LEVEL

<b>VENDORS</b>	152 Ramskeller Pub & Grub	<b>EVENT SPACE</b>	134 Meeting Room	<b>AMENITIES</b>	139 Laptop & Technology	<b>OFFICES</b>	118 Rocky Mountain Student Media Corporation
	175 CSU Bookstore		140 Meeting Room		150 Commons/Sunken Lounge		120 Career Center
	176 Bagel Place 2		144 Meeting Room		193 Campus Info 2		130 Campus Activities
	178 Cam's Lobby Shop		152A Microbrewery Classroom				141 Student Organization Resource Center
	197 Recycled Cycles						142 Fraternity & Sorority Life
							195 Transfort

### 200 LEVEL

<b>VENDORS</b>	203 Intermissions	<b>EVENT SPACE</b>	201H LSC Theatre	<b>AMENITIES</b>	200A Curfman Gallery	<b>OFFICES</b>	204 ASCSU Senate Chamber
	222 Sweet Sensations		212 Meeting Room		207 Diane Warren Kindness Lounge		206 Associated Students of Colorado State University
	244 RAMtech		226 Meeting Room	230 Study Room	240 Campus Info and Box Office		210 Student Leadership, Involvement & Community Engagement (SLICE)
	246 First National Bank		228 Meeting Room	236 Study Room			223 Student Disability Center
	252 Food Court			240 Campus Info and Box Office			225 El Centro
	Bagel Place						232 Pride Resource Center
	Freddy's						234 Women and Gender Advocacy Center
	Garbanzo						242 Colorado State University Police Department
	Mama Deluca's						274 Student Legal Services
	Panda Express						275 RamCard Office
	Spoons						276 LSC Business Services
	Subway						281 Off-Campus Life
	Taco Bell						282 Adult Learner and Veteran Services
	That's a Wrap						286 LSC Operations
	271 Canvas Credit Union						
	279 CSU Bookstore						

### 300 LEVEL

<b>VENDORS</b>	399B Aspen Grille	<b>EVENT SPACE</b>	Meeting Rooms	<b>AMENITIES</b>	316 Paul & Elsie Forsythe Legacy Lounge	<b>OFFICES</b>	303 Executive Director's Office
			300, 304, 306, 308, 310, 312, 322, 324, 328, 330, 372, 374, 376, 378, 380, 381A, 382, 384, 386, 390, 392, 394, 396, 398		320 Duhesa Gallery		315 Event Planning Services
			302 Longs Peak Room	326 Study Room	332 Study Room		327 Native American Cultural Center
			350 Grand Ballroom A-D	336 Study Room	337 Lactation Room		333 Asian/Pacific American Cultural Center
			357 Never No Summer (Né-cil-biceci?)	366 Reflection Room	368 Reflection Room		335 Black/African American Cultural Center
			398A University Ballroom	368 Reflection Room	387B Lactation Room		
			399 University Lounge				

### LEGEND

- RESTROOM
- CHANGING STATION
- ELEVATOR
- INFO DESK
- ALL-GENDER RESTROOM
- LACTATION ROOM
- WATER STATION
- AED

